



FEATURES

BMWC-L109S-1-BLE-KL is an Emergency Lighting Control Device which is in compliance to UL924. BMWC-L109S-1-BLE-KL needs to work together with BlueMesh smart lighting controllers and supporting products.

FEATURES

- Provision for remote test button or fire alarm interface.
- Dual color function LED indicator.
- Suitable for use in return air plenum Rated UL2043.
- Comply to UL1376,UL924,RoHS.
- Only 1 BMWC-L109S is recommended per Zone.
- Monitors normal power and activates emergency powered luminaires when normal power is loss.
- Can be programmed to send a command when normal power is restored.

PHYSICAL DIMENSIONS

Unit:inch/mm

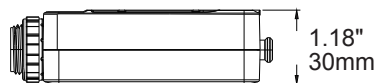
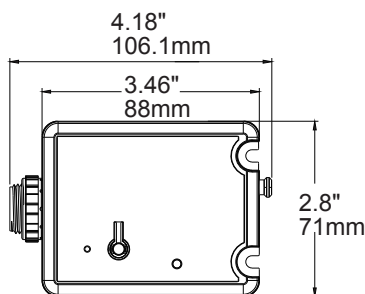

1/2inch US standard knockout

AMERICAN INCH PRODUCTS		
Size	T.P.I	Major Dia.
	inch	inch
R1/2	14	0.825

TECHNICAL DATA

Input Voltage: AC120-277V
 Frequency: 50/60Hz
 Input Current: 30mA
 Input Power: 5W

Bluetooth Transmit: 200ft Max
 Radio Frequency: 2.4GHz ± 75MHz
 Bluetooth Version: 5.0
 Housing Material: UL 94-5VA,
 Indoor Use Only
 Operating Temperature: -30°C to 50°C,
 -22°F to 122°F
 Storage Temperature: -30°C to 85°C,
 -22°F to 185°F
 IP Rating: IP20
 Color: Black
 Warranty: 5 years warranty

Comply to UL924,UL2043,UL1376,RoHS
 Safety: cULus Listed Emergency Lighting

ORDERING INFORMATION

MODEL	DESCRIPTION
BMWC-L109S-1-BLE-KL	Emergency Lighting & Power Equipment

WIRING DIAGRAM

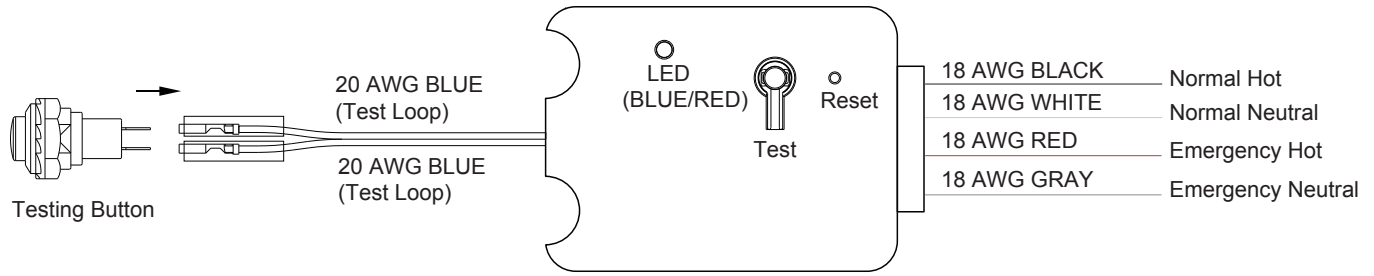

Ref#: 20240717

Blue/Red LED Indicator:
Blue - Normal Power Detected
Red - Emergency Mode/Normal Power Loss
Flashing Red - Emergency power is disrupted

WARRANTY

Five year limited warranty.

Specifications subject to change without notice.